

683

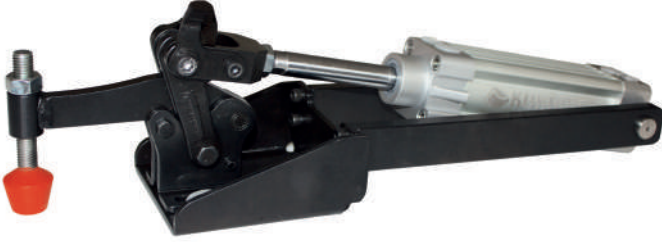

MODEL NO	F1 (N)	F3 (N)	Fi (N)	Vn (dm ³)	AÇI (ANGLE) (± 5 °)	AĞIRLIK (WEIGHT) (gr ±%2)	BAR
683 - 4	1600	5600	750	1,28	70°	4900	6
683 - 6	2000	11000	1150	2,5	70°	8000	6

F1 : BASKI KUVVETİ (EXERTING FORCE) , F3 : TUTMA KAPASİTESİ (HOLDING CAPACITY) , Fi : UYGULAMA KUVVETİ (APPLIED FORCE)

Vn , 6 BAR BASINÇTA ÇİFT HAREKET İÇİN HAVA TÜKETİM MİKTARIDIR (Vn , AIR CONSUMPTION PER DOUBLE STROKE IN dm³ AT 6 BAR)

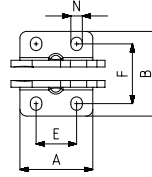
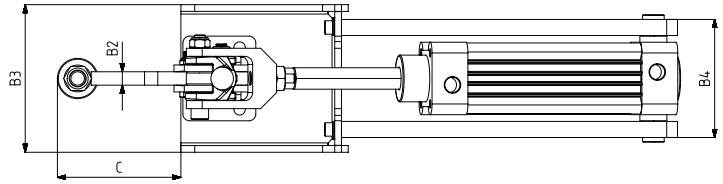
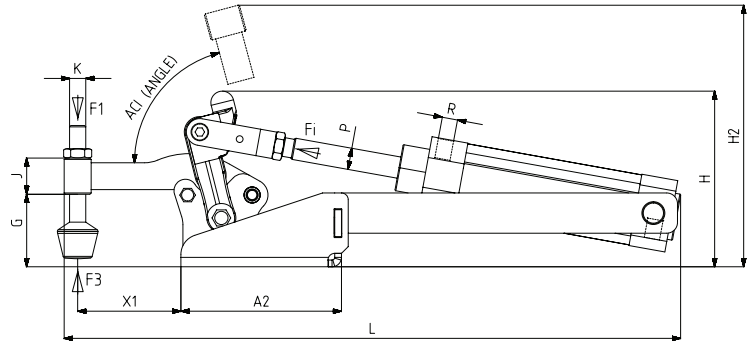

Ayak Tipi: Yatay Tabanlı (Modüler Pistonlu)
Body Mounting Base: Horizontal (Modular with piston)



683-H
Sayfa/Page: 95



6031
Sayfa/Page: 122



Pistonlar çift etkili, manyetik ve yastıklıdır.

Pneumatic cylinders are double acting, magnetic and cushioning.

MODEL NO	A	A2	B	B2	B3	B4	C	E	F	G	H	H2	J	K	L	N	X1	P	R	PİSTON Ø	PİSTON STROK
683 - 4	54	119	63	10	100	88	91,5	30	44,5	54	131	195	27	M12	457	8,5 x 10	76,5	Ø 16	G1/4	40	80
683 - 6	70	151	74	12	112	100	112	45	52	73	164	245	32	M12	549	10,5 x 11,5	97	Ø 20	G1/4	50	100