

Ayak Tipi: Yatay Tabanlı, Kaynaklı, Ön Bağlantılı
 Body Mounting Base: Horizontal With Welding, Tied Front



621
Sayfa/Page: 81



531
Sayfa/Page: 66

Pistonlar çift etkili, manyetik ve yastıklıdır.
 Pneumatic cylinders are double acting, magnetic and cushioning.

| MODEL NO | F1 (N) | F3 (N) | Fi (N) | Vn (dm ³) | STROK | AĞIRLIK (WEIGHT) (gr ±%2) | BAR |
|----------------|--------|--------|--------|-----------------------|-------|---------------------------|-----|
| 661 - 3 (Ø 12) | 1500 | 2960 | 300 | 0.25 | 23 | 880 | 6 |
| 661 - 3 (Ø 14) | 2500 | 3200 | 500 | 0.51 | 23 | 1026 | 6 |
| 661 - 4 (Ø 16) | 4500 | 6650 | 750 | 1.04 | 33 | 1816 | 6 |
| 661 - 4 (Ø 18) | 4500 | 7200 | 750 | 1.04 | 33 | 1836 | 6 |
| 661 - 5 (Ø 20) | 7500 | 15000 | 1100 | 2 | 42 | 3278 | 6 |

F1 : BASKI KUVVETİ (EXERTING FORCE), F3 : TUTMA KAPASİTESİ (HOLDING CAPACITY), Fi : UYGULAMA KUVVETİ (APPLIED FORCE)

Vn, 6 BAR BASINÇTA ÇİFT HAREKET İÇİN HAVA TÜKETİM MİKTARIDIR (Vn, AIR CONSUMPTION PER DOUBLE STROKE IN dm³ AT 6 BAR)

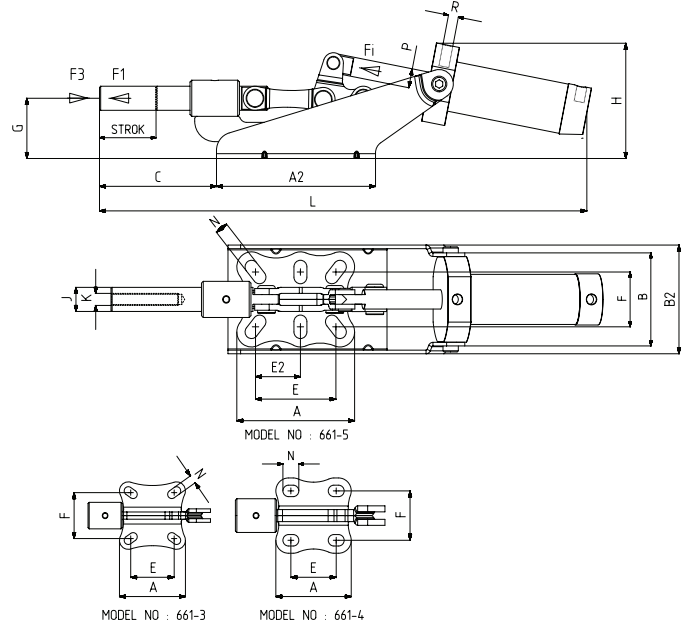

| MODEL NO | A | A2 | B | B2 | C | E | E2 | F | G | H | J | K | L | N | P | R | PİSTON Ø |
|----------------|-----|-----|----|----|-----|------|----|------|----|-----|----|-----|-----|------------|------|------|----------|
| 661 - 3 (Ø 12) | 56 | 90 | 51 | 68 | 70 | 37 | - | 38 | 35 | 72 | 12 | M8 | 292 | 7 x 12 | Ø 10 | G1/8 | 25 |
| 661 - 3 (Ø 14) | 56 | 100 | 58 | 68 | 70 | 37 | - | 38 | 35 | 79 | 14 | M8 | 312 | 7 x 12 | Ø 12 | G1/8 | 32 |
| 661 - 4 (Ø 16) | 64 | 115 | 77 | 78 | 84 | 38,5 | - | 41 | 43 | 100 | 16 | M10 | 372 | 9.5 x 13.5 | Ø 16 | G1/8 | 40 |
| 661 - 4 (Ø 18) | 64 | 115 | 77 | 78 | 84 | 38,5 | - | 41 | 43 | 100 | 18 | M10 | 372 | 9.5 x 13.5 | Ø 16 | G1/8 | 40 |
| 661 - 5 (Ø 20) | 100 | 170 | 79 | 92 | 101 | 68 | 38 | 45,5 | 51 | 110 | 20 | M12 | 456 | 11 x 22 | Ø 20 | G1/8 | 50 |



Ayak Tipi: Yatay Tabanlı, Kaynaklı, Ön Bağlantılı
 Body Mounting Base: Horizontal With Welding, Tied Front

Sensör Kanallı - Kare Pistonlu
 With Square Piston and Sensor Slot



661
Sayfa/Page: 87



533
Sayfa/Page: 69



534
Sayfa/Page: 71

Pistonlar çift etkili, manyetik ve yastıklıdır.
 Pneumatic cylinders are double acting, magnetic and cushioning.

| MODEL NO | F1 (N) | F3 (N) | Fi (N) | Vn (dm ³) | STROK | AĞIRLIK (WEIGHT) (gr ±%2) | BAR |
|----------------|--------|--------|--------|-----------------------|-------|---------------------------|-----|
| 662 - 3 (Ø 12) | 1500 | 2960 | 300 | 0.25 | 23 | 880 | 6 |
| 662 - 3 (Ø 14) | 2500 | 3200 | 500 | 0.51 | 23 | 1026 | 6 |

F1 : BASKI KUVVETİ (EXERTING FORCE), F3 : TUTMA KAPASİTESİ (HOLDING CAPACITY), Fi : UYGULAMA KUVVETİ (APPLIED FORCE)

Vn, 6 BAR BASINÇTA ÇİFT HAREKET İÇİN HAVA TÜKETİM MİKTARIDIR (Vn, AIR CONSUMPTION PER DOUBLE STROKE IN dm³ AT 6 BAR)

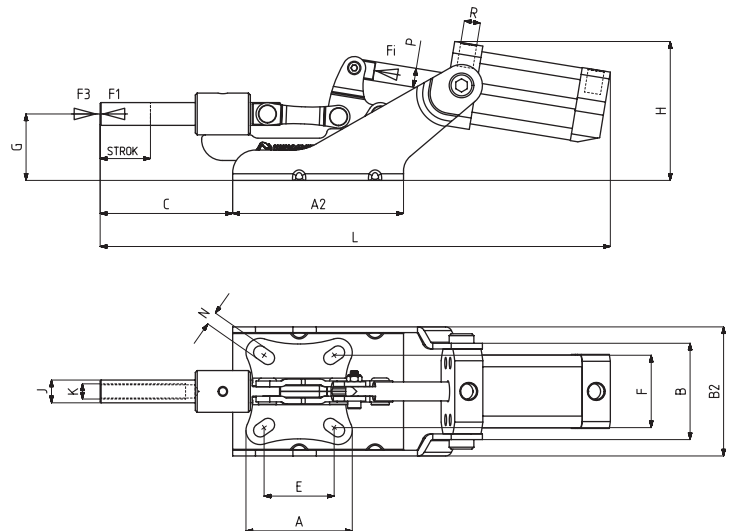

| MODEL NO | A | A2 | B | B2 | C | E | F | G | H | J | K | L | N | P | R | PİSTON Ø |
|----------------|----|-----|----|----|----|----|----|----|----|----|----|-----|--------|------|------|----------|
| 662 - 3 (Ø 12) | 56 | 90 | 51 | 68 | 70 | 37 | 38 | 35 | 73 | 12 | M8 | 268 | 7 x 12 | Ø 10 | G1/8 | 25 |
| 662 - 3 (Ø 14) | 56 | 100 | 58 | 68 | 70 | 37 | 38 | 35 | 80 | 14 | M8 | 288 | 7 x 12 | Ø 12 | G1/8 | 32 |