



MODEL NO	F1 (N)	F2 (N)	F3 (N)	F4 (N)	Fi (N)	Vn (dm ³)	AÇI (ANGLE) (± 5°)	AĞIRLIK (WEIGHT) (gr ±%2)	BAR
652 - 2	1200	700	1400	925	300	0,25	90°	570	6
652 - 3	2000	1400	2500	1560	500	0,51	90°	910	6

F1 - F2 : BASKI KUVVETİ (EXERTING FORCE), F3 - F4 : TUTMA KAPASİTESİ (HOLDING CAPACITY), Fi : UYGULAMA KUVVETİ (APPLIED FORCE)

Vn, 6 BAR BASINÇTA ÇİFT HAREKET İÇİN HAVA TÜKETİM MİKTARIDIR (Vn, AIR CONSUMPTION PER DOUBLE STROKE IN dm³ AT 6 BAR)

Ayak Tipi: Dik Tabanlı

Body Mounting Base: Vertical

Sensör Kanallı - Kare Pistonlu

With Square Piston and Sensor Slot

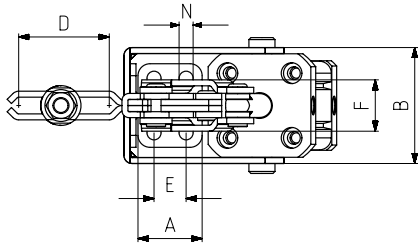
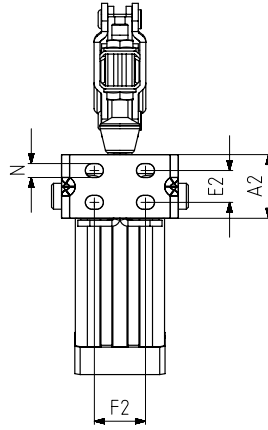
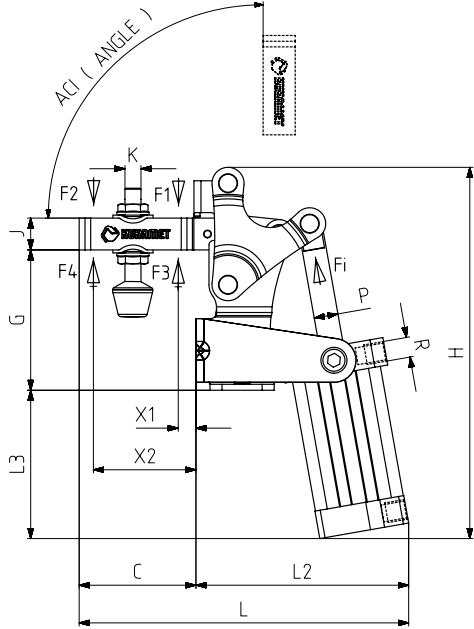

MODEL NO : 652-2

MODEL NO : 652-3

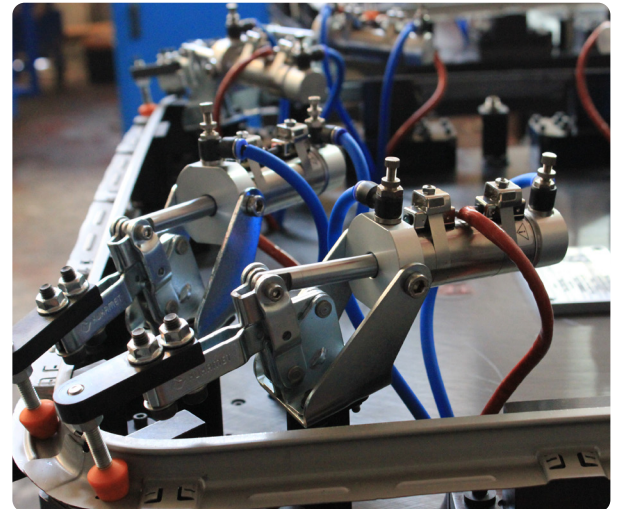
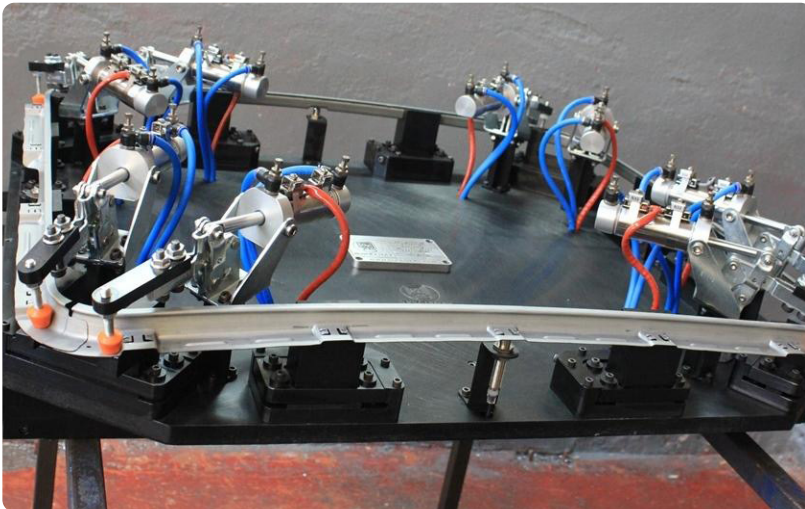

Pistonlar çift etkili, manyetik ve yastıklıdır

Pneumatic cylinders are double acting, magnetic and cushioning

MODEL NO	A	A2	B	C	D	E	E2	F	F2	G	H	J	K	L	L2	L3	N	X1	X2	P	R	PİSTON Ø
652 - 2	26	26	51	54	42	12,5	12,5	27	27	65	156	13	M6	145	91	59	6x8	12	42	Ø 10	G1/8	25
652 - 3	32	32	60	57	42	16	16	25,5	25,5	70,5	188	16	M8	165	108	76	7x9	15	42	Ø 12	G1/8	32