

511-Y

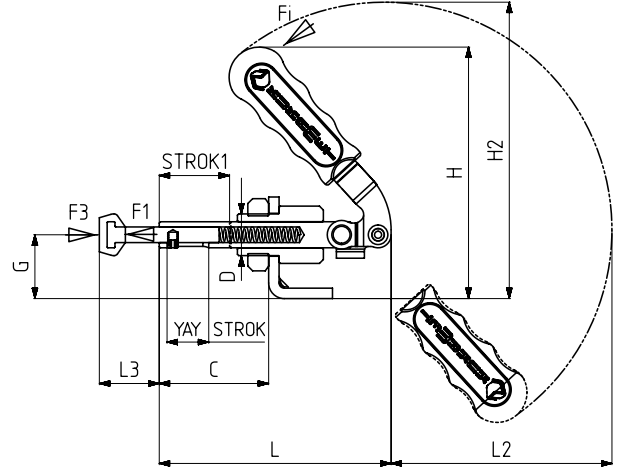

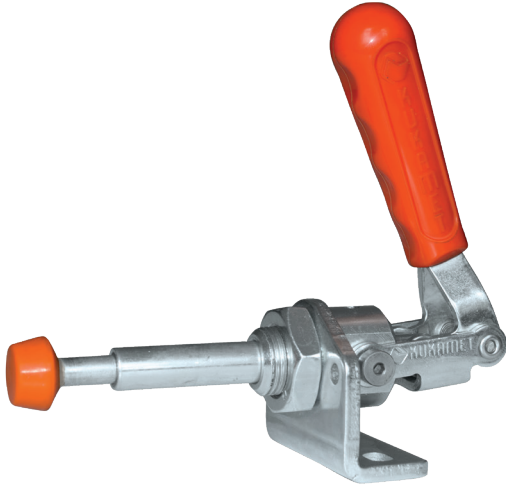



MODEL NO	F1 (N)	F3 (N)	F1 VERİM YIELD (F1:F1)	YAY STROK SPRING STROKE	STROK 1	AĞIRLIK (WEIGHT) (gr ±%)
511 - 1 - Y	230	280	24:1	10	22	142
511 - 2 - Y	550	620	26:1	12	27	260
511 - 3 - Y	1100	1160	27:1	14	38	470
511 - 5 - Y	1850	1950	38:1	16	53	930
511 - 6 - Y	2200	2270	38:1	16	53	1030

F1 : BASKI KUVVETİ ( EXERTING FORCE ) , F3 : TUTMA KAPASİTESİ ( HOLDING CAPACITY ) , F1 : UYGULAMA KUVVETİ ( APPLIED FORCE )

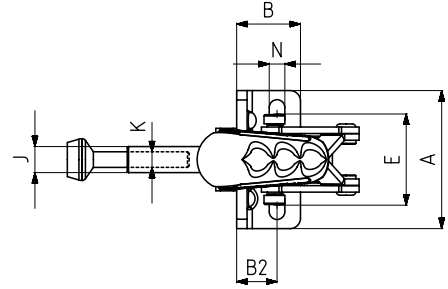

**Ayak Tipi: Yatay Tabanlı (Yaylı)**  
Body Mounting Base: Horizontal (Spring loaded)



-   
511  
Sayfa/Page: 54
-   
512  
Sayfa/Page: 56
-   
513  
Sayfa/Page: 56
-   
918  
Sayfa/Page: 122

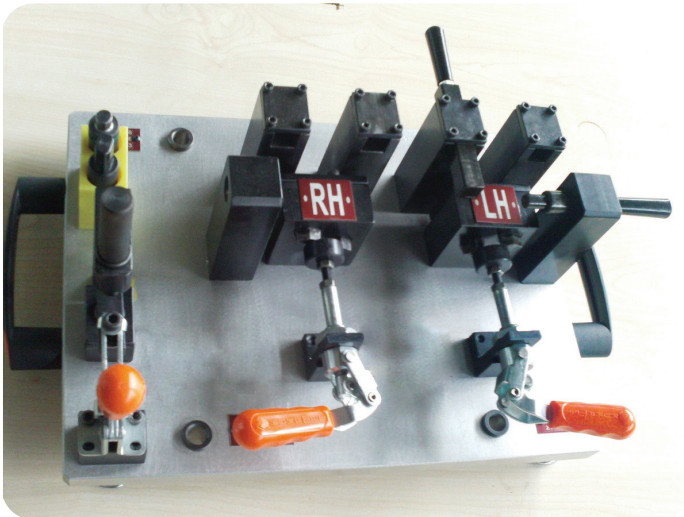

MODEL NO	A	B	B2	C	D	E	G	H	H2	J	K	L	L2	L3 Min	L3 Max	N
511 - 1 - Y	44	20	11,5	34	M12 x 1,5	26,5	19,5	79,5	92	8	M5	73	68,5	11,5	21,5	5,5 x 10,5
511 - 2 - Y	53	24,5	15,5	42	M16 x 1,5	35	24,5	96	111	10	M6	89	80	11	23	6 x 11
511 - 3 - Y	60	30	17,5	56	M20 x 1,5	38	30,5	137	140	12	M 8	116	80	13	27	6,5 x 11
511 - 5 - Y	78	36	21	75	M24 x 1,5	49,5	38	152	179	14	M10	155	135	17	33	8,5 x 16
511 - 6 - Y	78	36	21	75	M24 x 1,5	49,5	38	152	179	16	M10	155	135	17	33	8,5 x 16